

CMA-180/180Tall

Quick Setup Instructions

WARNING: Electrical and plumbing connections need to be made by a licensed service person and comply with all Federal, State and Local Health, Electrical, Plumbing and Safety codes.

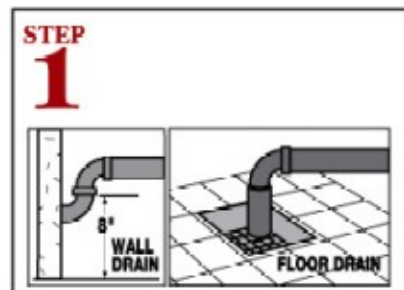

Connect a 2" drain pipe (not supplied) from scrap accumulator to floor or wall drain.

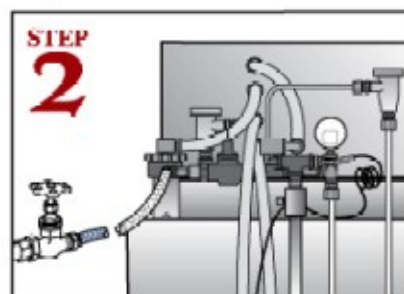

Connect dishmachine to hot water source—minimum 140°F if unit is equipped with a booster heater. If 140°F is not available, order a 2 minute time cycle (120°F minimum temperature required). A minimum of 180°F is required if unit is not equipped with a booster heater.

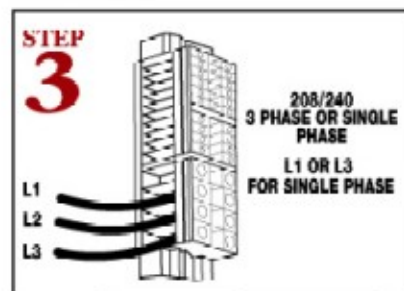

3 Phase: Connect power supply wires, L1, L2 and L3 to the appropriate terminals marked L1, L2 and L3 on the power block. **Important:** If one of the three wires has higher voltage it must be inserted as L-2.

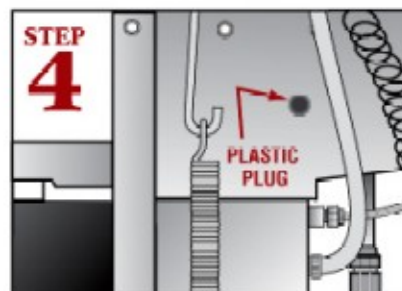
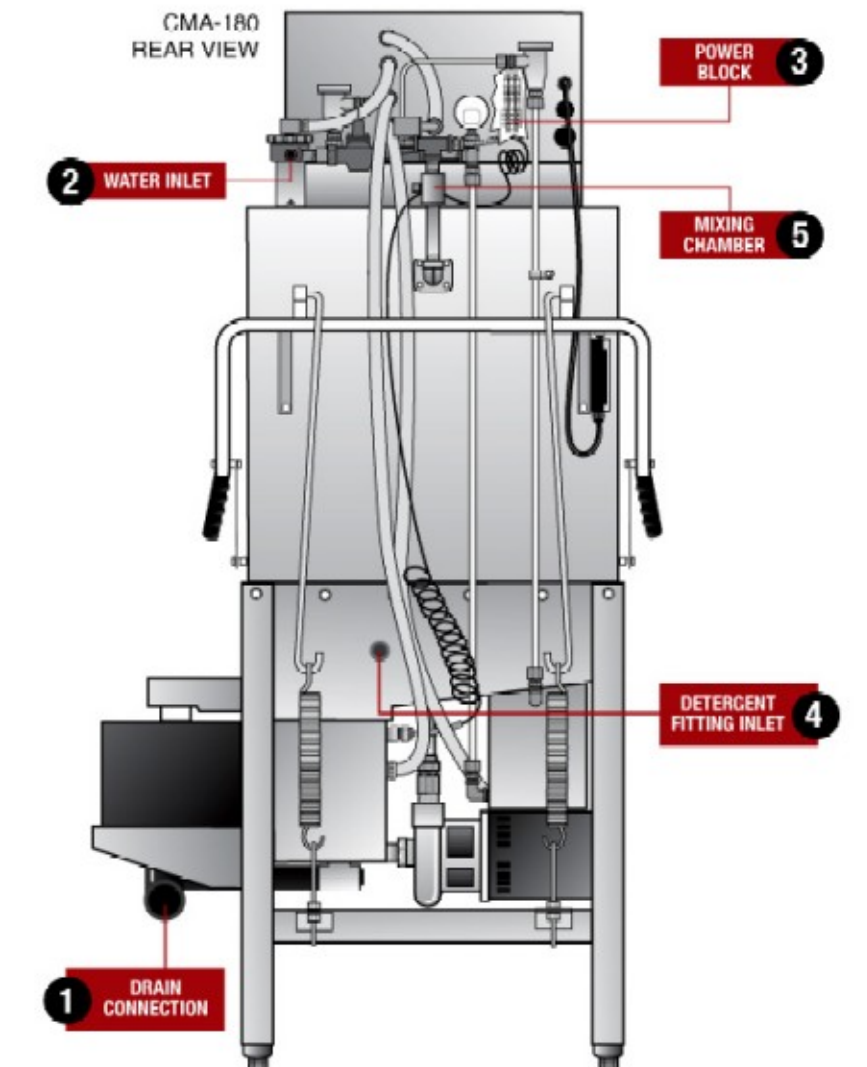

Remove the plastic plug to install the detergent fitting (provided by your dispenser supplier, CMA does not supply).

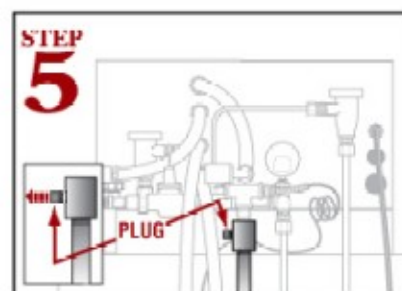

Remove the plug from the mixing chamber and install the rinse injection fitting (rinse injection fitting provided by your dispenser supplier, CMA does not supply).

CMA-180/180Tall

Quick Setup Instructions

WARNING: Electrical and plumbing connections need to be made by a licensed service person and comply with all Federal, State and Local Health, Electrical, Plumbing and Safety codes.



Press "POWER ON/OFF" rocker switch to turn on dishmachine.



Press "AUTO FILL" **immediately after power is turned on**. Rocker switch timer will automatically fill until the water overflows into the scrap trap. The initial fill may need to be pushed twice to fill booster and wash tank.



Open dishmachine doors completely. Closing the doors will automatically activate the machine.



Adjust the temperature by removing the panel in front of the respective heater and turning the adjustment post. Wash temp. 155°F. Rinse temp. 180°F.

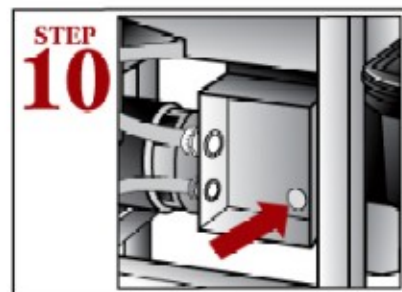

Remove the stainless steel plug to install the detergent probe (provided by your dispenser supplier, CMA does not supply).

