



EQUIPMENT UPDATE

Effective Date: MARCH 1, 2007

Log Number: EU-07-383

Part Description: CAM BEARING

Models Affected: CMA-44, CMA-66

New Part Number: 13507.60

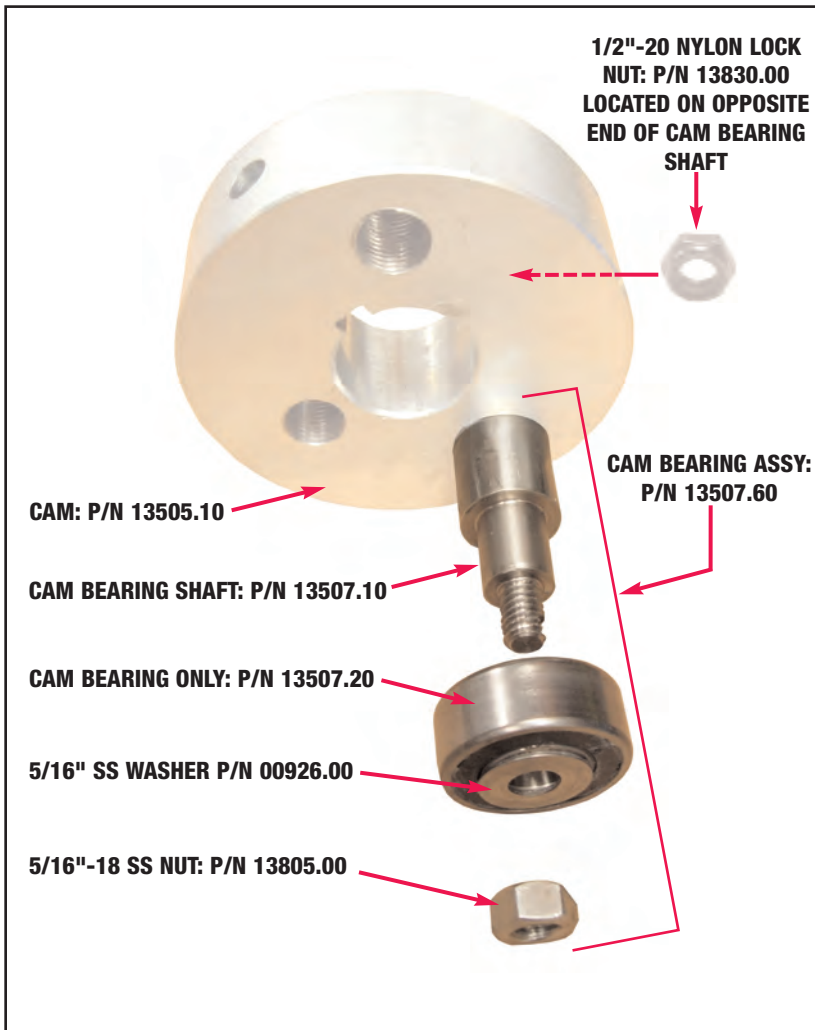

The new Cam Bearing is now much easier to service or replace. Remove retaining nut (CMA P/N 00913.00). Remove and replace bearing. The bearing shaft remains in place on Rocker Arm Cam. Keep bearing greased to prevent premature replacement.



12700 KNOTT AVENUE
GARDEN GROVE, CALIF. 92841
800-854-6417 • 714-898-8781
FAX 714-895-2141
www.cmadishmachines.com