

EQUIPMENT UPDATE



Date: 3/2/05

Log Number: EU-03-364

Subject: New NSF Requirement

Part: Sight Glass Chemical Flow Indicator

Models Affected: EVA, E, L-1X, L-1X16, GL-X & CWS

Sight Glass: Undercounter Part Number: 3426.00

Upright Part Number: 3425.00

SCOPE OF REQUIREMENT: Detergent/Sanitizer feeder must include a visual means to verify product is being delivered.

Models EVA, E, CWS

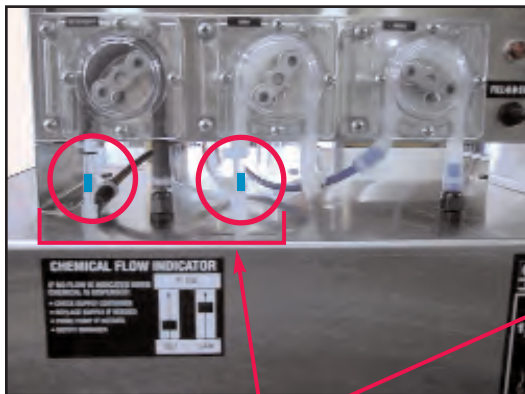

Models L-1X, L-1X16, GL-X

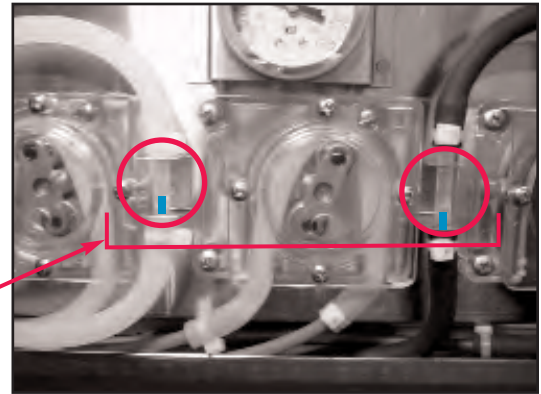

NOTE: Flow of product is indicated by movement of glass beads in sight glass.

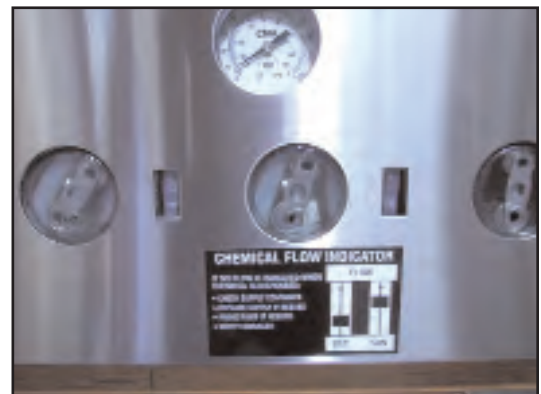

All future "Equipment Updates" will be sent by e-mail only. If you would like to receive "Equipment Updates", please forward your e-mail address to: tracee.santom@cmadishmachines.com .